

|            |                                 |
|------------|---------------------------------|
| 1/4        | BENZIN - Sichelmäher brillencio |
| 2004       | PETROL LAWN MOWER brillencio    |
| Upd: 11.04 | Tondeuses á gazon brillencio    |



Brillencio 43 B OHC - Art.62025



Gehäuse & Anbauteile  
Chassis & Components  
Chassis et Composants

Brillencio  
43 B OHC - Art.62025

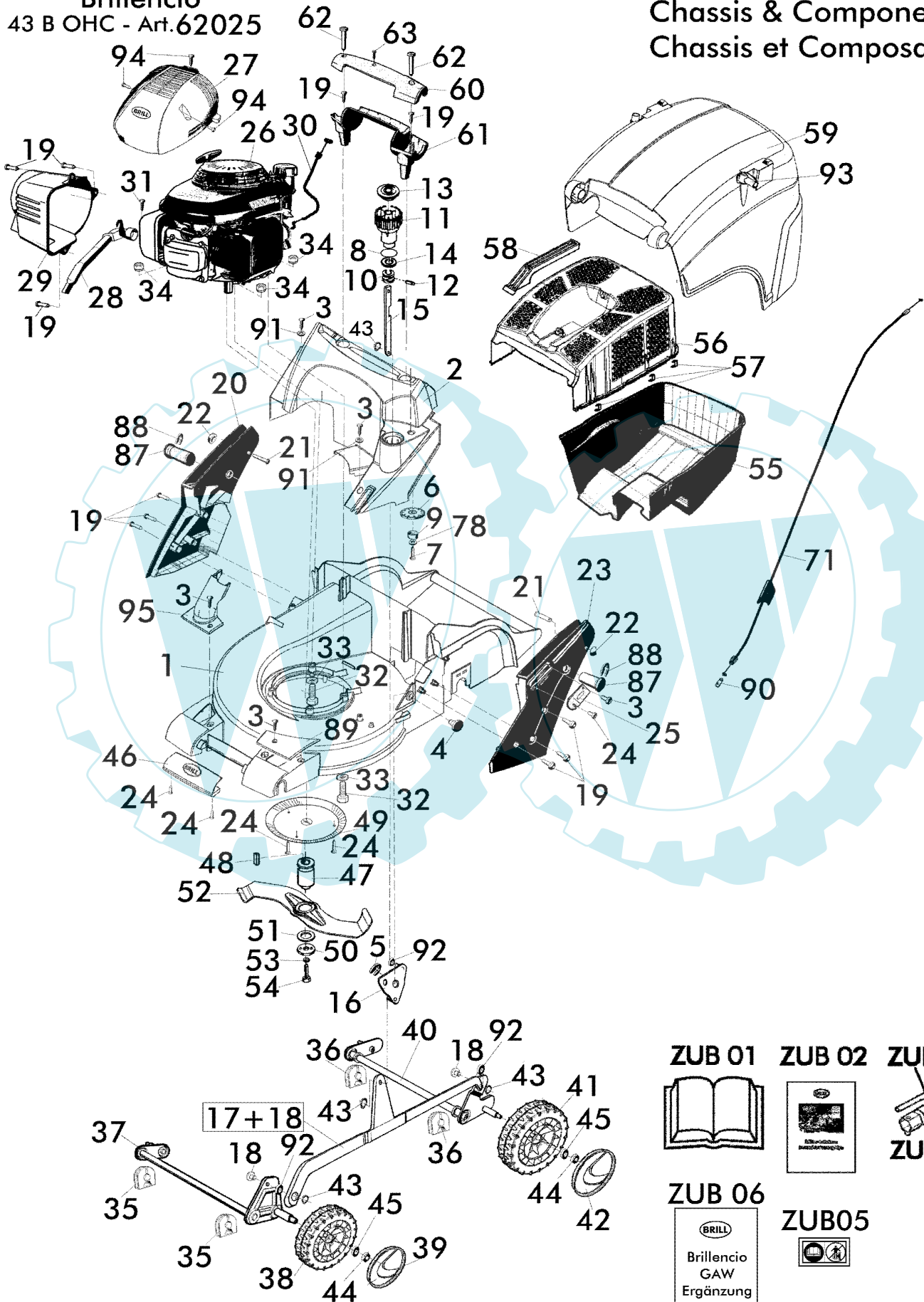

- ZUB 01
- ZUB 02
- ZUB 03
- ZUB 04
- ZUB 05
- ZUB 06

| 2/4                          |                                     | BENZIN - Sichelmäher <b>brillencio</b> |                                   |  | <b>Brillencio 43 B OHC - Art.62025</b> |
|------------------------------|-------------------------------------|--|-----------------------------------|--|--|
| 2004                         |                                     | PETROL LAWN MOWER <b>brillencio</b>    |                                   |  |  |
| Upd: 11.04                   |                                     | Tondeuses á gazon <b>brillencio</b>    |                                   |  |  |
| Bild Nr.<br>REF.N°<br>POS.N° | BEST.-NR.<br>PART-N°<br>N° d. PIECE | BEZEICHNUNG                            | DESCRIPTION                       | Anzahl<br>Qty.<br>Qte.   |  |
| 1                            | 13589                               | Gehäuse 43 Mg gep.RAL6001              | Chassis 43 B Mg RAL6001           | 1  |  |
| 2                            | 12958                               | Heckblende RAL6001                     | Rear end bezel                    | 1  |  |
| 3                            | 12723                               | Schraube DIN7500 NE M5*16-ST-Torx      | Screw DIN7500 NE M5*16-ST-Torx    | 4  |  |
| 4                            | 13222                               | Lagerbolzen                            | Bolt                              | 1  |  |
| 5                            | 06760                               | S-SCHEIBE 9 DIN6799-ST VERZ            | Circlip 9 DIN6799-ST VERZ         | 1  |  |
| 6                            | 10442                               | SKALENRAD BEDRUCKT                     | Scale wheel                       | 1  |  |
| 7                            | 13171                               | Blechschrabe ISO7049-St 6,3*13-C-      | Self-tapping screw 6,3x13         | 1  |  |
| 8                            | 08782                               | O-RING 12,1*2,7 70 SHORE A,            | O-Ring 12,1*2,7 70 SHORE A,       | 1  |  |
| 9                            | 13170                               | Lager Skala                            | Scale bearing                     | 1  |  |
| 10                           | 08606                               | VERSTELLBOLZEN                         | Adjustment bolt                   | 1  |  |
| 11                           | 13252                               | VERSTELKNOPF                           | Adjustment knob                   | 1  |  |
| 12                           | 08607                               | ZYLINDERSTIFT 10H8*22 DIN7-ST VERZ     | Parallel pin 10H8*22 DIN7-ST VERZ | 1  |  |
| 13                           | 13169                               | Deckel bedr.                           | Cover                             | 1  |  |
| 14                           | 08610                               | LAGERSCHEIBE                           | Disk                              | 1  |  |
| 15                           | 12942                               | Zugstange gep RAL7021                  | Pull rod                          | 1  |  |
| 16                           | 13463                               | Schwinge kpl verz.                     | Rocker                            | 1  |  |
| 17+18                        | 13466                               | VERBINDUNGSSTANGE mont.                | Con-rod assy.                     | 1  |  |
| 18                           | 13071                               | ZUGBOLZEN                              | Tension bolt                      | 2  |  |
| 19                           | 13173                               | SCHRAUBE DIN7500 M6*20 Torx            | Screw DIN7500 M6*20 Torx          | 8  |  |
| 20                           | 13335                               | Holmknoten rts RAL7045                 | Bar joint right RAL7045           | 1  |  |
| 21                           | 13796                               | Bolzen                                 | Bolt                              | 2  |  |
| 22                           | 13198                               | Sperrkappe 6 SBK 1863 vern.            | Arrestor cap                      | 2  |  |
| 23                           | 13336                               | Holmknoten lks RAL 7045                | Bar joint left RAL7045            | 1  |  |
| 24                           | 13232                               | SCHRAUBE DIN7500 M5*12 Torx verz       | Screw DIN7500 M5*12 Torx verz     | 5  |  |
| 25                           | 13209                               | Bowdenzughalter                        | Cable connector                   | 1  |  |
| 26                           | 13119                               | V-Motor Honda GCV135-S2-E1-SD          | V-Motor Honda GCV135-S2-E1-SD     | 1  |  |
| 27                           | 12971                               | Motorhaube Honda                       | Motor cover Honda                 | 1  |  |
| 28                           | 12972                               | Abgasrohr kpl Honda 135                | Flue gas pipe assy Honda GCV 135  | 1  |  |
| 29                           | 12985                               | Auspuffschutz Honda gep.silber         | Exhaust guard Honda               | 1  |  |
| 30                           | 13249                               | Bowdenzug Bremse Honda PS              | Brake cable                       | 1  |  |
| 31                           | 13232                               | SCHRAUBE M5*12 DIN7500 Torx,verz.      | Screw M5*12 DIN7500 Torx,verz.    | 1  |  |
| 32                           | 13799                               | SKT-Schraube M8x80 DIN 931-8.8 verz    | Hex.Hd.Screw M8x80 DIN 931-8.8    | 3  |  |
| 33                           | 07500                               | SCHEIBE A8,4*25*3 AEHNL,DIN902         | Washer                            | 3  |  |
| 34                           | 08427                               | SPERRZAHNMUTTER M8,KL,8                | Special nut M8                    | 3  |  |
| 35                           | 12944                               | Lagerschale vorn                       | Front Bearing Seat                | 2  |  |
| 36                           | 09027                               | LAGERSCHALE HINTEN RAL9005             | Rear Bearing seat                 | 2  |  |
| 37                           | 12945                               | Vorderachse kpl gepulv.RAL7021         | Front axle assy.                  | 1  |  |
| 38                           | 12946                               | Laufrad 172 kpl m.Kugellager           | Wheel 172 assy.w.ball bearing     | 2  |  |
| 39                           | 12947                               | Radkappe 172 Silencio                  | Wheel cap 172 Silencio            | 2  |  |
| 40                           | 13759                               | Hinterachse kpl verz.                  | Rear Axle Assy.                   | 1  |  |
| 41                           | 12989                               | Laufrad 195 kpl m.Kugellager           | Wheel 195 Assy. W.ball bearing    | 2  |  |
| 42                           | 12952                               | Radkappe 195 Silencio                  | Wheel cap 195 Silencio            | 2  |  |
| 43                           | 10574                               | S-SCHEIBE 6 DIN6799 ROH                | Circlip 6                         | 4  |  |
| 44                           | 06684                               | SKT-MUTTER M 8 DIN985-8 VERZ           | Hex.Hd.Nut M8                     | 4  |  |
| 45                           | 06465                               | SCHEIBE A8,4 DIN125-ST VERZ            | Washer                            | 4  |  |
| 46                           | 12961                               | Griffschale vorn gepulvert             | Grip jacket                       | 1  |  |
| 47                           | 12990                               | Messerflansch Honda                    | Blade flange honda                | 1  |  |
| 48                           | 02713                               | KEIL WOODRUFF505 5/32*51               | Woodruff Key                      | 1  |  |
| 49                           | 13450                               | ABDECKSCHEIBE GEP RAL7021              | Barrier                           | 1  |  |
| 50                           | 08654                               | SPANNSCHEIBE GEP RAL2002               | Tension Screw                     | 1  |  |
| 51                           | 08740                               | REIBSCHEIBE , MIT WERKS BES,DIN        | Friction disk                     | 1  |  |
| 52                           | 13968                               | Messer 43 gep.                         | Duo-Cutting Blade 43              | 1  |  |

| <b>3/4</b>                   | <b>BENZIN - Sichelmäher brillencio</b> |                                   |                                    |  |
|------------------------------|--|-----------------------------------|------------------------------------|--|
| 2004                         | <b>PETROL LAWN MOWER brillencio</b>    |                                   | <b>BRILL</b>                       | <b>Brillencio 43 B OHC - Art.62025</b> |
| Upd: 11.04                   | <b>Tondeuses á gazon brillencio</b>    |                                   |                                    |  |
| Bild Nr.<br>REF.N°<br>POS.N° | BEST.-NR.<br>PART-N°<br>N° d. PIECE    | BEZEICHNUNG                       | DESCRIPTION                        | Anzahl<br>Qty.<br>Qte.                 |
| 53                           | 06460                                  | SCHEIBE A10,5 DIN125-ST VERZ      | Washer                             | 1                                      |
| 54                           | 07489                                  | SKT-SCHRAUBE 3/8"24UNF 2 3/4"-8,8 | Tension Screw 3/8"24UNF 2 3/4"-8,8 | 1                                      |
| 55                           | 13735                                  | Fangkorb UT                       | Lower Grass Catcher 43             | 1                                      |
| 56                           | 13734                                  | Fangkorb OT                       | Upper Grass Catcher 43             | 1                                      |
| 57                           | 12970                                  | Verbindungsklammer FK Silencio    | Clamp                              | 7                                      |
| 58                           | 08252                                  | TRAGEGRIFF ROT, LOSE              | Grip                               | 1                                      |
| 59                           | 12967                                  | Multi-Funktions-Box RAL6001       | Grass Box Cover                    | 1                                      |
| 60                           | 12965                                  | Heckgriff OT gepulvert silber     | Rear grip, Upper part              | 1                                      |
| 61                           | 12963                                  | Heckgriff UT gepulvert silber     | Rear grip, Lower part              | 1                                      |
| 62                           | 13231                                  | SCHRAUBE M6*40 DIN7500 Torx,verz. | Screw                              | 2                                      |
| 63                           | 13230                                  | SCHRAUBE M4*20 DIN7500 Torx,verz. | Screw                              | 1                                      |
| 71                           | 12999                                  | Bowdenzug Bremse Holm             | Upper Brake Cable 1                | 1                                      |
| 78                           | 06843                                  | SCHEIBE A5,3 DIN9021 VERZ         | Washer                             | 3                                      |
| 87                           | 13460                                  | Gelenkbolzen                      | Joint bolt                         | 2                                      |
| 88                           | 13156                                  | S-Scheibe DIN6799-19-SnBz8        | Circlip                            | 2                                      |
| 89                           | 13175                                  | Abdeckung lks                     | Cover left                         | 1                                      |
| 90                           | 13248                                  | Bowdenzugverbinder                | Cable connector                    | 1                                      |
| 91                           | 06843                                  | SCHEIBE B5,3 DIN9021 VERZ         | Washer                             | 2                                      |
| 92                           | 08399                                  | FESCH B8,4*15*0,2 DIN137 VERZ     | Serrated washer                    | 3                                      |
| 93                           | 12996                                  | Mitnehmer                         | Tappet                             | 2                                      |
| 94                           | H93903-24480                           | Schneidschraube                   | Hood Screw                         | 3                                      |
| 95                           | 12987                                  | Auspuffschutz Geh.rts.gep.silber  | Muffler guard right                | 1                                      |
|                              |  | <b>ZUBEHOER</b>                   | <b>ACCESSORIES</b>                 |  |
| ZUB01                        | 13350                                  | GEBRAUCHSANWEISUNG Brillencio     | Instruction for use Brillencio     | 1                                      |
| ZUB02                        | 00563                                  | KUNDENDIENSTVERZEICHNIS           | Brill-Service-Booklet              | 1                                      |
| ZUB03                        | 06574                                  | STECKSCHLÜSSEL DIN659 SW19/21     | Box spanner SW 19/21               | 1                                      |
| ZUB04                        | 06591                                  | DREHSTIFT 5x100 DIN900 VERZ       | Pin 5x100                          | 1                                      |
| ZUB05                        | 13778                                  | Geräteaufkleber "Kippen"          | Label "tipping"                    | 1                                      |
| ZUB06                        | 13895                                  | GAW Ergänzung 62025               | Instruction added information      | 1                                      |

|            |  |
|------------|--|
| 4/4        | BENZIN - Sichelmäher <b>brillencio</b> |
| 2004       | PETROL LAWN MOWER <b>brillencio</b>    |
| Upd: 11.04 | Tondeuses á gazon <b>brillencio</b>    |



Brillencio 43 B OHC - Art.62025

Gestänge,  
Handle Bar,  
Manche

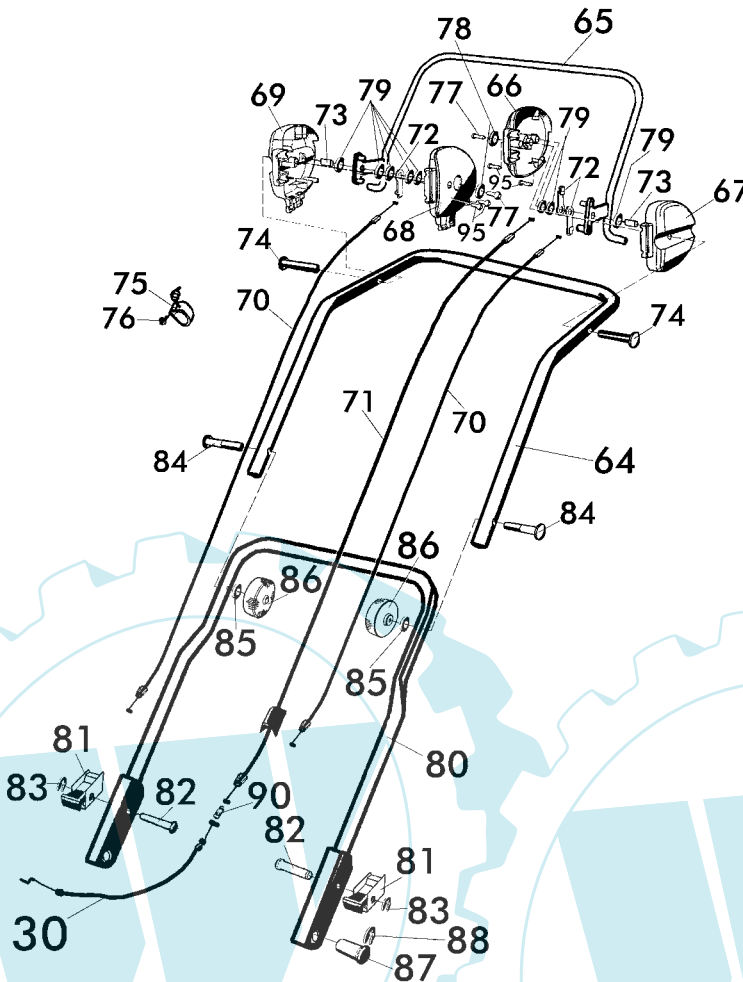

| Bild Nr.<br>REF.N°<br>POS.N° | BEST.-NR.<br>PART-N°<br>N° d. PIECE | BEZEICHNUNG                        | DESCRIPTION                 | Anzahl<br>Qty.<br>Qte. |
|------------------------------|-------------------------------------|------------------------------------|-----------------------------|------------------------|
| 30                           | 13249                               | Bowdenzug Bremse Honda PS          | Brake cable                 | 1                      |
| 64                           | 13141                               | GESTÄNGE-OBERTEIL                  | Upper handle bar            | 1                      |
| 65                           | 13000                               | Bremsbügel kpl gep.RAL2002         | Brake bail assy.            | 1                      |
| 66                           | 13462                               | Holmgehäuse lks innen bedruckt     | Bar housing left inboard    | 1                      |
| 67                           | 13472                               | Holm-Gehäuse lks außen             | Bar housing left ambient    | 1                      |
| 68                           | 13470                               | Holm-Gehäuse rts innen             | Bar housing right inboard   | 1                      |
| 69                           | 13471                               | Holm-Gehäuse rts außen             | Bar housing right ambient   | 1                      |
| 70                           | 12998                               | Bowdenzug-Entriegelung             | Cable lock-out release      | 2                      |
| 71                           | 12999                               | Bowdenzug Bremse Holm              | Upper Brake Cable 1         | 1                      |
| 72                           | 13150                               | Bowdenzugmitnehmer                 | Cable tappet                | 3                      |
| 73                           | 13151                               | ZYLINDERSTIFT ISO2338-B-8*24-St    | Pin ISO2338-B-8*24-St*-verz | 2                      |
| 74                           | 13901                               | Isolierhülse                       | Palstic Bolt                | 2                      |
| 75                           | 10953                               | UMLENKHALTER                       | Cable guide                 | 1                      |
| 76                           | 08722                               | LIB-SCHRAUBE BZ 3,5*13 DIN7981 V2A | Screw                       | 1                      |
| 77                           | 13444                               | LIB-Schraube ISO 7049-4,8x19 Torx  | Screw ISO 7049-4,8x19 Torx  | 2                      |
| 78                           | 06843                               | SCHEIBE A5,3 DIN9021 VERZ          | Washer                      | 2                      |
| 79                           | 06465                               | SCHEIBE A8,4 DIN125-ST VERZ        | Washer                      | 8                      |
| 80                           | 12979                               | GESTÄNGE-UNTERTEIL gep.RAL7021     | Lower handle bar            | 1                      |
| 81                           | 13510                               | Sperrklinke mont.                  | Catch Assy.                 | 2                      |
| 82                           | 13140                               | Bolzen                             | Bolt                        | 2                      |
| 83                           | 06755                               | S-SCHEIBE 5 DIN6799 VERZ           | Circlip 5                   | 2                      |
| 84                           | 09191                               | FORMSCHRAUBE M8*47 N ZG            | Special form screw          | 2                      |
| 85                           | 06465                               | SCHEIBE A8,4 DIN125-ST VERZ        | Washer                      | 2                      |
| 86                           | 13294                               | Holm-Spanngriff                    | bar tension grip            | 2                      |
| 87                           | 13460                               | Gelenkbolzen                       | Joint bolt                  | 2                      |
| 88                           | 13156                               | S-Scheibe DIN6799-19-SnBz8         | Circlip                     | 2                      |
| 90                           | 13248                               | Bowdenzugverbinder                 | Cable connector             | 1                      |
| 95                           | 12032                               | ZK-Schraube 3,5x20 KB              | ZK-screw 3,5x20 KB          | 4                      |